

RVE

**REMINGTON
& VERNICK
ENGINEERS**

2059 SPRINGDALE ROAD
CHERRY HILL, NJ 08003
(856) 795-9595, FAX (856) 795-1382
WEB SITE ADDRESS: WWW.RVE.COM

Certification of Authorization: 24 USA 20030360
—ENGINEERING EXCELLENCE—

DATE: **06/14/2025**

STEPHANIE A. CUTHBERT
NJ PROFESSIONAL ENGINEER LIC. NO. 42136

<p>ALL INFORMATION CONTAINED HEREIN IS UNCLASSIFIED EXCEPT WHERE SHOWN OTHERWISE BY A DATE AND AUTHORITY. THIS DOCUMENT IS IN THE PUBLIC DOMAIN AND IS NOT TO BE REPRODUCED OR TRANSMITTED IN ANY FORM OR BY ANY MEANS, ELECTRONIC OR MECHANICAL, INCLUDING PHOTOCOPYING, RECORDING, OR BY ANY INFORMATION STORAGE AND RETRIEVAL SYSTEM.</p>			
1	CHANGING HEADLINE OF COUNTRY	01/1975	001
2			
3			
4			
5			
6			
7			
8			
9			
10			
11			
12			
13			
14			
15			
16			
17			
18			
19			
20			
21			
22			
23			
24			
25			
26			
27			
28			
29			
30			
31			
32			
33			
34			
35			
36			
37			
38			
39			
40			
41			
42			
43			
44			
45			
46			
47			
48			
49			
50			
51			
52			
53			
54			
55			
56			
57			
58			
59			
60			
61			
62			
63			
64			
65			
66			
67			
68			
69			
70			
71			
72			
73			
74			
75			
76			
77			
78			
79			
80			
81			
82			
83			
84			
85			
86			
87			
88			
89			
90			
91			
92			
93			
94			
95			
96			
97			
98			
99			
100			

CAMDEN CITY	CAMDEN COUNTY	NEW JERSEY
-------------	---------------	------------



AUGUST 2025

SHEET INDEX	
SHEET#	DESCRIPTION
T-1	TITLE SHEET
G-1	GENERAL NOTES
G-2	LEGEND
C-1	PROPOSED SITE PLAN
C-2	PROPOSED SITE PLAN PHASE 2
SESC-1	SOIL EROSION AND SEDIMENT CONTROL DETAILS
D-1	DETAILS

DESIGNED BY G.M.	CHECKED BY G.M.	APPROVED BY S.C.	SCALE AS NOTED
DATE 9/20/04		SHEET No. T-1	
JOB No. 3905X004			

1. ALL WATER AND WASTE WATER FACILITIES SHALL BE CONSTRUCTED IN ACCORDANCE WITH NEW JERSEY MUNICIPAL WATER COMPANY (NJWC) GDS. CSDA CONSERVATION DISTRICT A NEW JERSEY DEPARTMENT OF ENVIRONMENTAL PROTECTION (NJDEP) STANDARD SPECIFICATIONS.
2. CONTRACTOR SHALL VERIFY ALL DIMENSIONS AND EXISTING CONDITIONS IN THE FIELD BY THE CONTRACTOR PRIOR TO THE START OF THE CONSTRUCTION, ANY ERRORS OR DISCREPANCIES SHALL BE BROUGHT TO THE ATTENTION OF THE ENGINEER IMMEDIATELY.
3. LOCATION OF EXISTING UTILITIES ARE APPROPRIATE AND MUST BE VERIFIED BY THE CONTRACTOR IN THE FIELD PRIOR TO THE START OF CONSTRUCTION.
4. THE CONTRACTOR SHALL USE EXCAVATED MATERIALS FOR BACKFILL, UNLESS OTHERWISE DIRECTED BY THE ENGINEER.
5. ALL PAVED AND CONCRETE MASSES THAT DISTURBED DURING CONSTRUCTION SHALL BE RESTORED TO EXISTING CONDITION AT LEAST EQUAL TO THAT WHICH EXISTED PRIOR TO THE START OF CONSTRUCTION.
6. ALL FILL SHALL BE PLACED IN 12" LAYERS AND THOROUGHLY COMPACTED TO THE SATISFACTION OF THE ENGINEER.
7. THE CONTRACTOR SHALL BE RESPONSIBLE FOR THE LOCATION AND PRESERVATION OF THE UNDERGROUND AND SURFACE UTILITIES AND STRUCTURES AT OR ADJACENT TO THE SITE OF CONSTRUCTION AND IT SHALL BE THE CONTRACTOR'S RESPONSIBILITY TO PROTECT THEM FROM ANY DAMAGE THAT IT CAUSES.
8. BASELINES HAVE BEEN PROVIDED ON THE PLANS. IT SHALL BE THE CONTRACTOR'S RESPONSIBILITY TO LOCATE THE BASELINE AS SHOWN ON THE PLAN.
9. APPROXIMATE DEPTH OF ALL WATER MAIN IS 4 FEET.
10. APPROXIMATE DEPTH OF ALL ELECTRIC MAIN IS 4 FEET.
11. APPROXIMATE DEPTH OF ALL GAS MAIN IS 3 FEET.
12. ALL CONSTRUCTION DETAIL NOT SHOWN SHALL BE IN ACCORDANCE WITH N.J.D.O.T. STANDARDS AS DETAILED

* "STANDARD ROADWAY CONSTRUCTION/TRAFFIC CONTROL/BRIDGE CONSTRUCTION DETAILS."
* "ELECTRICAL BUREAU STANDARD DETAILS: 2001."
INCLUDING ALL APPLICABLE BASELINE DOCUMENT CHANGES AND APPENDICES, THESE DETAILS MAY BE PURCHASED THROUGH THE N.J.D.O.T. PLANS AND SPECIFICATION CENTER AT:
1035 PARKWAY AVENUE,
TRENTON, NEW JERSEY
08625-0600
(TELEPHONE: 1-609-539-2098)

- SEPARATE PAYMENT WILL NOT BE MADE FOR SAW CUTTING OF ANY KIND, BUT THE COST SHALL BE INCLUDED IN THE PRICE OF THE CONCRETE.
- PAYMENT FOR JOINT MATERIAL FOR ALL CONCRETE WORK WILL NOT BE MEASURED BUT SHALL BE INCLUDED IN THE VARIOUS ITEMS OF THE PROPOSAL.
- TRAFFIC CONTROL, INCLUDING TRAFFIC CONTROL, MAINTENANCE AND PROTECTION OF TRAFFIC AND SHALL BE ACCORDANCE WITH THE LATEST NJ DEPARTMENT OF TRANSPORTATION STANDARDS.
- MANHOLE CASTINGS THAT ARE TO BE RESET SHALL BE RESET $\frac{1}{2}$ INCH THAN THE PROPOSED PAVEMENT DEPTH.
- THE NEW JERSEY DEPARTMENT OF TRANSPORTATION (NJDOT) STANDARD SPECIFICATION FOR ROAD AND BRIDGE CONSTRUCTION ADOPTED WITH THE 2010 STATE AID SUPPLEMENTAL SPECIFICATION AS MODIFIED SHALL GOVERN.
- ALL UNUSED MATERIAL EXCAVATED FROM THE PROJECT SITE ARE TO BE DISPOSED OF AT AN APPROVED FACILITY. THE CONTRACTOR IS RESPONSIBLE FOR TESTING OF SOIL TO BE REMOVED FROM THE SITE.
- THE CONTRACTOR SHALL BE RESPONSIBLE FOR OBTAINING ALL NECESSARY PERMITS AND EROSION CONTROL MEASURES INDICATED IN THE PLANS AND SPECIFICATIONS. SEPARATE PAYMENT FOR ALL ASSOCIATED COSTS WILL NOT BE MADE. THE CONTRACTOR SHALL BE RESPONSIBLE FOR OBTAINING ALL NECESSARY PERMITS.
- THE CONTRACTOR SHALL ANTICIPATE GROUND WATER INFILTRATION OCCURRING THROUGHOUT THE COURSE OF THE VARIOUS TASKS ASSOCIATED WITH THIS PROJECT. ALL COSTS ASSOCIATED WITH THE TEMPORARY BYPASS OF THE INFILTRATION OF GROUND WATER SHALL BE INCLUDED IN THE PRICE OF THE PROPOSED WORK.
- ALL UTILITY WORK SHALL BE CONSTRUCTED TO ALLOW UNINTERRUPTED SERVICE TO ADJACENT PROPERTIES.
- EXISTING WATER MAIN, SANITARY SEWER, GAS MAIN STORM SEWER, ELECTRICAL SERVICES AND ALL OTHER UTILITIES SHALL BE IDENTIFIED AND MAINTAINED DURING INSTALLATION OF THE PROPOSED UTILITY WORK, SERVICES AND LATERALS.
- THE CONTRACTOR SHALL BE RESPONSIBLE FOR KEEPING THE PAVED TRAVEL PATH FREE AND CLEAR OF ALL OBSTRUCTIONS TO TRAFFIC. THE CONTRACTOR SHALL BE RESPONSIBLE FOR MAINTAINING A CLEAR WORK AREA, EMPT CONDITION AND OR AS DIRECTED BY THE ENGINEER.
- THE ELEVATION OF THE EXISTING WATER MAIN AS SHOWN ON THE DRAWINGS IS ASSUMED. THE CONTRACTOR SHALL BE RESPONSIBLE FOR VERIFYING THE ELEVATION OF THE EXISTING WATER MAIN PRIOR TO ANY CONSTRUCTION.
- ALL CONNECTIONS TO THE EXISTING WATER MAIN SHALL BE REPLACED. THE INSTALLATION OF NEW FIRE SERVICE LATERALS/OFFSETS SHALL INCLUDE COMPLETED STABILIZATION MATERIAL FOR FULL LENGTH OF CROSSING.
- ALL UTILITY CROSSINGS/OFFSETS SHALL INCLUDE COMPLETED STABILIZATION MATERIAL FOR FULL LENGTH OF CROSSING.
- SEPARATE PAYMENT WILL NOT BE MADE FOR EXCAVATION, Dewatering, FITTINGS, PIPE, BEDDING, SHEETING, BRACING, SHIELDING, JUMP CONNECTIONS, TRAPS, AND SURFACE BODILY DAMAGE, REPAIRED AT ALL IN THE PROJECT AND ASSOCIATED STRUCTURES REMOVED, RECONSTRUCTION AND INSTALLATION, BUT THE COST SHALL BE INCLUDED IN THE PRICE OF THE PROPOSED WORK.
- THE CONTRACTOR SHALL EXPOSE PARTICULAR CARE, ESPECIALLY AT INTERSECTIONS AND GUTTER LINES, IN MILLING AND CONSTRUCTION OF PAVEMENT TO PROTECT POSITIVE FLOWING STORMWATER. ANY AREAS WHERE EXISTING STORMWATER FLOW IS INTERRUPTED SHALL BE RECONSTRUCTED TO MAINTAIN POSITIVE FLOW.
- ALL WORK TO BE COORDINATED WITH SEPARATE CONTRACTORS FOR ONGOING WORK IN AREAS SURROUNDING THE PROJECT.
- AT ALL LIMITS OF PAVING (L.O.P.) THE CONTRACTOR SHALL SAWCUT, TACK COAT AND SEAL TO MATCH EXISTING PAVEMENT. SEPARATE MEASUREMENT AND PAYMENT FOR ALL THIS WORK SHALL NOT BE MADE AND SHALL BE INCLUDED IN THE PRICE OF THE PROPOSED WORK.
- SEAL/SLURRY PROTECTION SHALL BE INSTALLED AT ALL EXISTING AND PROPOSED RIGS AND CATCH BASINS SHOWN ON THE PLANS. SEPARATE PAYMENT WILL NOT BE MADE, BUT SHALL BE INCLUDED IN THE PRICE OF THE PROPOSED WORK.
- THE CONTRACTOR SHALL NOT BE PERMITTED TO UTILIZE ANY FORM OF HMA VIBRATORY ROLLER OR OTHER ROLLER COMPACTOR ON THIS PROJECT. ALTERNATE COMPACTOR TECHNIQUES, SUCH AS STATIC TAMPERS, SHALL BE APPROVED BY THE ENGINEER.
- STAINLESS STEEL BOLTS ARE TO BE USED FOR ALL BURIED BOLTS.
- POLYETHYLENE GLASS SHALL BE USED ON ALL DUCTILE IRON PIPING, FITTINGS & APPURTENANCES.

ENVIRONMENTAL COMMITMENTS:

1. IMPLEMENT SOIL EROSION AND SEDIMENT CONTROL MEASURES DURING CONSTRUCTION.
2. IMPLEMENT STANDARD MEASURE FOR CONSTRUCTION RELATED NOISE AND AIR QUALITY IMPACT CONTROLS.
3. BEST MANAGEMENT PRACTICE WILL BE UTILIZED DURING CONSTRUCTION TO PREVENT SEDIMENT FROM ENTERING STORM WATER INLETS AND ENVIRONMENTALLY SENSITIVE AREAS.
4. CONSTRUCTION STAGING ACTIVITIES (INCLUDING STORAGE OF EQUIPMENT, VEHICLES AND MATERIALS) ARE PROHIBITED IN THE ENVIRONMENTALLY SENSITIVE OR GREEN AREAS ENCUMBERED PROPERTIES.
5. IF CONTACT WITH THE NORTHERN LONG-EARED BAT IS MADE DURING MAINTENANCE OPERATION, CONSULTATION WITH USFWS AND BEPR WILL BE REQUIRED.

[illegible]

STANDARD LEGEND

NOTE: ALL SYMBOLS MAY NOT BE USED

ITEM	DESCRIPTION	EXISTING	PROPOSED	ITEM	DESCRIPTION	EXISTING	PROPOSED	ITEM	DESCRIPTION	EXISTING	PROPOSED
UTILITIES	OVERHEAD WIRE	—	—	SURVEY	BENCHMARK LOCATION			SITE & ROADWORK	EDGE OF PAVEMENT	—	—
	SANITARY FORCE MAIN PIPE	—	—		CROWS FOOT	Y			CURB	—	—
	STORM SEWER PIPE ≤ 12"	—	(SIZE & TYPE)		AERIAL TARGET	+	■ (SET)		PAVEMENT / CONC. / SIDEWALK		CONCRETE SIDEWALK
	STORM SEWER PIPE > 12"	—	(SIZE & TYPE)		CONCRETE MONUMENT	+	◆ (SET)				PAVEMENT, FULL DEPTH RESTORATION
	GAS SERVICE	—	—		PK / MAG NAIL / DRILL HOLE / SPIKE	•	◆ (SET)				PAVEMENT MILLING
	SANITARY SEWER PIPE ≤ 12"	—	(SIZE & TYPE)		DRILL HOLE W/ WINGS	+	◆ (SET)				DRIVEWAY RESTORATION, ASPHALT
	SANITARY SEWER PIPE > 12"	—	(SIZE & TYPE)		STAKE	Δ	Δ (SET)				DRIVEWAY RESTORATION, BRICK
	ELECTRIC SERVICE	—	—		HUB	Δ	Δ (SET)				DRIVEWAY RESTORATION, CONCRETE
	FIBER OPTIC SERVICE	—	—		FIN W/ CAP	•	◆ (SET)				DRIVEWAY RESTORATION, STONE
	TELEPHONE SERVICE	—	—		IRON PIPE	•	◆ (SET)				
	COMMUNICATIONS SERVICE	—	—		CROSS CUT	■	■ (SET)				
	IRRIGATION PIPE	—	—		DISK	□					
	FIRE SERVICE	—	—		STONE	□					
	WATER SERVICE	—	—		REBAR	•					
	WATER SHUT-OFF	+	+		BASELINE	—	—				
	WATER METER	+	+		CENTERLINE	—	—				
	WATER VALVE	+	+		EASEMENT	—	—				
	WATER HYDRANT	+	+		RIGHT-OF-WAY	—	—				
	WELL	+	+		PROPERTY BOUNDARY	—	—				
	YARD HYDRANT	+	+		ADJACENT PROPERTY BOUNDARY	—	—				
UTILITIES	METER PIT	+	+	ENVIRONMENTAL	RAILROAD TRACKS	—	—	ABBREVIATIONS	DETECTABLE WARNING SURFACE	—	—
	GAS SHUT-OFF	+	+		STATE BOUNDARY	—	—		TYPICAL STRIPING	—	—
	GAS METER	+	+		MUNICIPAL / COUNTY BOUNDARY	—	—		ADA STRIPING	—	—
	GAS VALVE	+	+						TRAFFIC CONTROL BOX	—	—
	GAS LINE MARKER	+	+						TRAFFIC LIGHT	—	—
	CLEANOUT	+	+						DEPT. OF TRANSPORTATION MANHOLE	—	—
	SEWER VENT	+	+						STATE HIGHWAY DEPARTMENT	—	—
	INLET TYPE A	+	+						RAILROAD CROSSING BEACON	—	—
	INLET TYPE B	+	+						CALL BOX	—	—
	INLET TYPE E	+	+						OIL FILL	—	—
	AREA DRAIN	+	+						UNDERGROUND STORAGE TANK LID	—	—
	MANHOLES	+	+						RISER PIPE	—	—
	HEADWALL	+	+						RAISED PAVEMENT MARKER	—	—
	HEADWALL W/ WINGS	+	+						TYPICAL NORTH ARROW	—	—
	IRRIGATION CONTROL VALVE	+	+								
	IRRIGATION BOX	+	+								
	IRRIGATION CONTROL BOX	+	+								
	SPRINKLER HEAD	+	+								
	UNKNOWN VALVE	+	+								
UTILITIES	COMMUNICATIONS PEDESTAL	+	+	LANDSCAPING	GRASS/BOG	—	—	DRAWING NOMENCLATURE REPRESENTATION			
	COMMUNICATIONS LINE MARKER	+	+		DECIDUOUS TREE	—	—				
	TELEPHONE PEDESTAL	+	+		SHRUBS / BUSH	—	—				
	TELEPHONE LINE MARKER	+	+		EVERGREENS	—	—				
	ELEC. BOX	+	+		STUMP	—	—				
	ELEC. METER	+	+		WOODS / TREE LINE	—	—				
	ELEC. TRANSFORMER PAD	+	+		WIRE FENCE	—	—				
	ELEC. VAULT	+	+		SPLIT RAIL FENCE	—	—				
	ELEC. LINE MARKER	+	+		WOOD / VINYL FENCE	—	—				
	UTILITY POLE	+	+		CHAIN-LINK FENCE	—	—				
	GUY ANCHOR	+	+								
	ELEC. OUTLET	+	+								
	LIGHTS	+	+								
	VENT	+	+								
	VENT PIPE	+	+								

RYE
REMINGTON & VERNICK ENGINEERS
 2058 SPRINGDALE ROAD
 CHERRY HILL, NJ 08003
 (609) 795-5595 FAX (609) 795-1883
 WWW.RVE.COM
 PROFESSIONAL ENGINEERING REG. NO. 42136

DATE: 08/14/2025
STEPHANIE A. CUTHBERT
 NJ PROFESSIONAL ENGINEER - NO. 42136

NO.	DATE	DESCRIPTION
1	08/14/2025	ISSUED FOR PERMIT
2	08/14/2025	ISSUED FOR PERMIT
3	08/14/2025	ISSUED FOR PERMIT
4	08/14/2025	ISSUED FOR PERMIT
5	08/14/2025	ISSUED FOR PERMIT
6	08/14/2025	ISSUED FOR PERMIT
7	08/14/2025	ISSUED FOR PERMIT
8	08/14/2025	ISSUED FOR PERMIT
9	08/14/2025	ISSUED FOR PERMIT
10	08/14/2025	ISSUED FOR PERMIT
11	08/14/2025	ISSUED FOR PERMIT
12	08/14/2025	ISSUED FOR PERMIT
13	08/14/2025	ISSUED FOR PERMIT
14	08/14/2025	ISSUED FOR PERMIT
15	08/14/2025	ISSUED FOR PERMIT
16	08/14/2025	ISSUED FOR PERMIT
17	08/14/2025	ISSUED FOR PERMIT
18	08/14/2025	ISSUED FOR PERMIT
19	08/14/2025	ISSUED FOR PERMIT
20	08/14/2025	ISSUED FOR PERMIT

LEGEND
 SOUTH BERRY POINT CAMP
 BUILDING Y-2 EMERGENCY FIRE MAIN REPAIR
 CAMDEN COUNTY
 CAMDEN CITY
 NEW JERSEY

NO.	DATE	DESCRIPTION
1	08/14/2025	ISSUED FOR PERMIT
2	08/14/2025	ISSUED FOR PERMIT
3	08/14/2025	ISSUED FOR PERMIT
4	08/14/2025	ISSUED FOR PERMIT
5	08/14/2025	ISSUED FOR PERMIT
6	08/14/2025	ISSUED FOR PERMIT
7	08/14/2025	ISSUED FOR PERMIT
8	08/14/2025	ISSUED FOR PERMIT
9	08/14/2025	ISSUED FOR PERMIT
10	08/14/2025	ISSUED FOR PERMIT
11	08/14/2025	ISSUED FOR PERMIT
12	08/14/2025	ISSUED FOR PERMIT
13	08/14/2025	ISSUED FOR PERMIT
14	08/14/2025	ISSUED FOR PERMIT
15	08/14/2025	ISSUED FOR PERMIT
16	08/14/2025	ISSUED FOR PERMIT
17	08/14/2025	ISSUED FOR PERMIT
18	08/14/2025	ISSUED FOR PERMIT
19	08/14/2025	ISSUED FOR PERMIT
20	08/14/2025	ISSUED FOR PERMIT

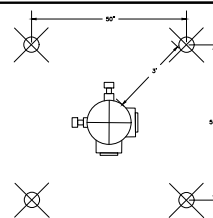

PAVEMENT RESTORATION

-
- RESTRICTION
- 1'-0"
- EDGE OF TRENCH
- 1'-0"
- DGA TO EXISTING GRADE
- EXISTING PAVEMENT THICKNESS VARIES
- VARIES
- BACKFILL IN ACCORDANCE WITH GENERAL SPECIFICATIONS
- MINIMUM WIDTH OF TRENCH TO THE INSIDE OF THE DEPTH PROPOSED PIPELINE
- 1'-0" MIN.
- 1'-0" MIN.
- DGA TO EXISTING GRADE
- (SEE PLAN FOR LOCATION AND SIZE AS DIRECTED BY THE ENGINEER)
- DGA TRENCH DETAIL D.I. PIPE
- N.T.S.

DBA TRENCH DETAIL D.I. PIPE

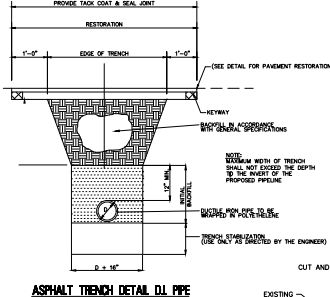

ASPHALT TRENCH DETAIL D.I. PIPE

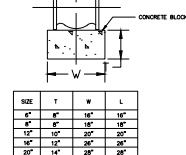

VALVE SUPPORT

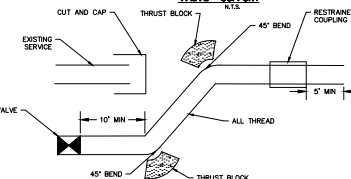

VALVE HOUSE CONNECTION DETAIL

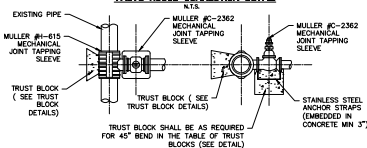

- NOTES:**
1. TAPPED CONNECTIONS SHALL BE MADE ONLY IN THE PRESENCE OF WATER DEPARTMENT EMPLOYEES OR THEIR DESIGNATED REPRESENTATIVE.
 2. CONCRETE THRUST BLOCK UNDER VALVES SHALL HAVE A SOIL BEARING AREA EQUAL TO THAT OF A 45° ELBOW.
 3. CONCRETE THRUST BLOCK UNDER TAPPING SLEEVE SHALL HAVE A SOIL BEARING AREA EQUAL TO THAT OF A TEE CONNECTION.

TAPPING SLEEVE AND VALVE DETAIL

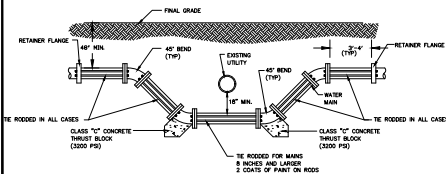

WATER MAIN OFF-SET DETAIL

MINIMUM SIZE OF CONCRETE THRUST BLOCKS												
Type of Thrust	90° KNOTS			45° KNOTS			22-1/2° KNOTS			RECURS		
	A	B	C	A	B	C	A	B	C	A	B	C
1" or LESS	1'-0"	6"	1'-0"	1'-3"	6"	1'-3"	1'-0"	6"	1'-0"			
2"	1'-6"	8"	1'-6"	1'-9"	8"	1'-9"	1'-3"	8"	1'-3"			
4"	2'-0"	8"	1'-6"	2'-6"	8"	2'-0"	1'-6"	8"	1'-3"			
6"	2'-6"	8"	2'-0"	3'-0"	10"	2'-6"	2'-0"	10"	1'-6"			
8"	3'-0"	10"	2'-6"	3'-6"	12"	3'-0"	2'-6"	12"	1'-6"			
10"	3'-6"	10"	3'-0"	4'-0"	12"	3'-6"	3'-0"	12"	1'-6"			
12"	3'-6"	10"	3'-0"	4'-6"	12"	3'-6"	3'-0"	12"	1'-6"			
14"	3'-0"	10"	3'-0"	4'-6"	15"	4'-6"	4'-6"	15"	3'-6"			

90° KNOTS		45° KNOTS		22-1/2° KNOTS		RECURS	
A	B	A	B	A	B	A	B

1. THRUST BLOCKS TO BE USED FOR WATER MAIN AND FORCE MAINS AT ALL BENDS, TEES, REDUCERS AND PLUGS.
2. BEARING AREAS FOR THRUST BLOCKS ARE BASED ON THE UNDISTURBED SOIL WITH BEARING CAPACITY OF 2000 POUNDS PER SQ. FT. FOR OTHER SOILS OF LESS BEARING CAPACITY, THE AREAS SHALL BE ADJUSTED ACCORDINGLY, (FIG. 14, SEE THIRTEEN DESIGN FOR FURTHER INFORMATION, 1978).
3. ALL CONCRETE FOR THRUST BLOCKS SHALL BE 3000 PSI COMPRESSIVE STRENGTH WITHIN 28 DAYS.
4. THE THRUST BLOCKS SHALL BE POURED FROM FITTING SUCH THAT THEY BEAR ON THE UNDISTURBED WALL OF THE TRENCH.
5. THE TABULATED CONTACT BEARING AREAS LISTED ARE FOR HORIZONTAL AND DOWNWARD THRUST ONLY AND ARE NOT APPLICABLE FOR UPWARD THRUST.

THRUST BLOCK DETAIL FOR SYSTEMS AT 150 PSI TEST PRESSURE OR LESS

NTS